**COPPER TUBE CRIMPING LUGS ACCORDING TO NF C 20-130 ADD. I - TYPE T-M
for copper conductors****Description:**

- T-M series lugs are manufactured from electrolytic copper tube Cu-OF CW008A conform to UNI EN 13600:2003. The dimensions of the tube are designed to obtain the most efficient electrical conductivity and mechanical strength to resist vibration and pull out.
- Lugs are electrolytically tin plated with a minimum thickness of 3µm to avoid oxidation.
- Cembre lugs are annealed to guarantee optimum ductility which is an absolute necessity for connectors which will have to withstand the severe deformation arising when compressed and any bending of the palm during installation.
- In applications subject to vibration, terminals still have to perform a reliable connection, annealing plays a vital role in avoiding cracking or breaks between the barrel and palm.
- The presence of an inspection hole facilitates full insertion of the conductor, whilst the barrel length has been designed to allow easy and accurate positioning of the dies during the crimping operation.
- The belled end assists flexible wire insertion and provides smooth cable strain relief during cable flexing and movement.

Each connector is marked as follows:

- Cembre trade mark and reference number.
- Size of conductor (mm²).
- Ø stud (mm).

Cembre SpA

Via Serenissima, 9 - 25135 Brescia (Italy)

Tel.: +39 030 36921 - Fax: +39 030 3365766

Web: www.cembre.com - Email: info@cembre.com

COPPER TUBE CRIMPING LUGS ACCORDING TO NF C 20-130 ADD. I - TYPE T-M for copper conductors

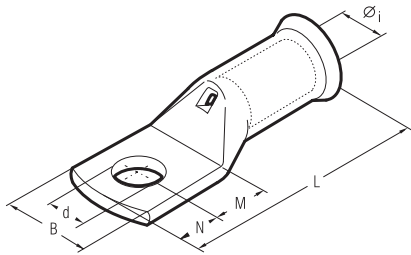
Sections and Dimensions:

Cond. Size sqmm	Ø Stud mm	Ref.	Dimensions mm					
			Øi	B	M	N	L	d
4	4	T 4 - M 4	2,7	9,0	7,0	6,0	27,5	4,2
	5	T 4 - M 5	2,7	9,0	7,0	6,0	27,5	5,2
	6	T 4 - M 6	2,7	12,0	9,0	8,0	32,0	6,4
4:6	4	T 6 - M 4	3,3	10,0	6,5	6,0	30,0	4,2
	5	T 6 - M 5	3,3	13,0	6,5	6,0	30,0	5,2
	6	T 6 - M 6	3,3	13,0	9,0	8,0	34,5	6,4
8	8	T 6 - M 8	3,3	13,0	11,0	10,0	38,5	8,3
	5	T 10 - M 5	4,2	11,0	6,5	6,0	30,0	5,2
	6	T 10 - M 6	4,2	11,0	9,0	8,0	34,5	6,4
10	8	T 10 - M 8	4,2	14,0	11,0	10,0	38,5	8,3
	10	T 10 - M 10	4,2	14,0	14,0	12,0	43,5	10,3
	5	T 16 - M 5	5,3	12,0	6,5	6,0	34,0	5,2
16	6	T 16 - M 6	5,3	12,0	9,0	8,0	38,5	6,4
	8	T 16 - M 8	5,3	16,0	11,0	10,0	42,5	8,3
	10	T 16 - M 10	5,3	16,0	14,0	12,0	47,5	10,3
25	6	T 25 - M 6	6,6	13,0	9,0	8,0	40,0	6,4
	8	T 25 - M 8	6,6	16,0	11,0	10,0	44,0	8,3
	10	T 25 - M 10	6,6	16,0	14,0	12,0	49,0	10,3
35	6	T 35 - M 6	7,9	15,0	9,0	8,0	41,0	6,4
	8	T 35 - M 8	7,9	17,0	11,0	10,0	45,0	8,3
	10	T 35 - M 10	7,9	17,0	14,0	12,0	50,0	10,3
50	12	T 35 - M 12	7,9	17,0	18,0	16,0	58,0	12,8
	6	T 50 - M 6	9,2	18,0	9,0	8,0	46,5	6,4
	8	T 50 - M 8	9,2	18,0	11,0	10,0	50,5	8,3
70	10	T 50 - M 10	9,2	18,0	14,0	12,0	55,5	10,3
	12	T 50 - M 12	9,2	19,0	18,0	16,0	63,5	12,8
	8	T 70 - M 8	11,0	21,0	11,0	10,0	54,0	8,3
95	10	T 70 - M 10	11,0	21,0	14,0	12,0	59,0	10,3
	12	T 70 - M 12	11,0	21,0	18,0	16,0	67,0	12,8
	8	T 95 - M 8	13,1	23,0	11,0	10,0	60,0	8,3
120	10	T 95 - M 10	13,1	23,0	14,0	12,0	65,0	10,3
	12	T 95 - M 12	13,1	23,0	18,0	16,0	73,0	12,8
	14	T 95 - M 14	13,1	23,0	18,0	16,0	73,0	14,5
	16	T 95 - M 16	13,1	23,0	19,0	17,0	75,0	16,5
150	8	T 120 - M 8	14,5	28,0	11,0	10,0	63,0	8,3
	10	T 120 - M 10	14,5	28,0	14,0	12,0	68,0	10,3
	12	T 120 - M 12	14,5	28,0	18,0	16,0	76,0	12,8
	14	T 120 - M 14	14,5	28,0	18,0	16,0	76,0	14,5
185	16	T 120 - M 16	14,5	28,0	19,0	17,0	78,0	16,5
	10	T 150 - M 10	16,2	30,0	14,0	12,0	77,5	10,3
	12	T 150 - M 12	16,2	30,0	18,0	16,0	85,5	12,8
	14	T 150 - M 14	16,2	30,0	18,0	16,0	85,5	14,5
240	16	T 150 - M 16	16,2	30,0	19,0	17,0	87,5	16,5
	10	T 185 - M 10	18,0	33,0	14,0	12,0	83,5	10,3
	12	T 185 - M 12	18,0	33,0	18,0	16,0	91,5	12,8
	14	T 185 - M 14	18,0	33,0	18,0	16,0	91,5	14,5
300	16	T 185 - M 16	18,0	33,0	19,0	17,0	93,5	16,5
	10	T 240 - M 10	20,6	37,0	13,0	11,0	87,5	10,3
	12	T 240 - M 12	20,6	37,0	16,0	14,0	93,5	12,8
	14	T 240 - M 14	20,6	37,0	18,0	16,0	97,5	14,5
400	16	T 240 - M 16	20,6	37,0	19,0	17,0	99,5	16,5
	20	T 240 - M 20	20,6	37,0	22,0	20,0	105,5	21,0
	10	T 300 - M 10	23,1	41,0	14,0	11,0	95,0	10,3
	12	T 300 - M 12	23,1	41,0	20,0	14,0	104,0	12,8
300	14	T 300 - M 14	23,1	41,0	22,0	16,0	108,0	14,5
	16	T 300 - M 16	23,1	41,0	22,0	19,0	111,0	16,5
	20	T 300 - M 20	23,1	41,0	24,0	23,0	117,0	21,0
400	16	T 400 - M 16	26,1	47,0	22,0	19,0	119,0	16,5
	20	T 400 - M 20	26,1	47,0	24,0	23,0	125,0	21,0

Cembre SpA



Via Serenissima, 9 - 25135 Brescia (Italy)

Tel.: +39 030 36921 - Fax: +39 030 3365766

Web: www.cembre.com - Email: info@cembre.com

COPPERTUBE CRIMPING LUGS ACCORDING TO NF C 20-130 ADD. I - TYPE T-M for copper conductors

Die selection:

APPLICATION	CONDUCTOR		CONNECTOR		HYDRAULIC TOOLS									
					B 15		B 35-45D			B 35-50D			HT 45	
	low stranded	flexible	LUGS	SPLICE	DIE SET	NEST	INDENTOR	DIE SET	NEST	INDENTOR	DIE SET	NEST	INDENTOR	DIE SET
 T-M.	4 ÷ 6		T 6 - M..	L 6 - T..	MS 4/10-15 (1)	MA 1 (Y)	PA 1	MS 6 (1)	MA 1-50 (Y)	PA 1-50	MS 6-50 (1)	MA 1 (Y)	PA 1	MS 6 (1)
	10		T 10 - M..	L 10 - T..	MS 4/10-15 MS 10/16-15 (1)	MA 2.3 (Y)	PA 5	MS 10 (1)	MA 2.3-50 (Y)	PA 5-50	MS 10-50 (1)	MA 2.3 (Y)	PA 5	MS 10 (1)
	16		T 16 - M..	L 16 - T..	MS 10/16-15 (1)	MA 5 (Y)		MS 16 (1)	MA 5-50 (Y)		MS 16-50 (1)	MA 5 (Y)		MS 16 (1)
	25		T 25 - M..	L 25 - T..			MS 25 (1)	MA 5-50 (Y)		MS 25-50 (1)	MS 25 (1)			
 L-T	35	25	T 35 - M..	L 35 - T..		MA 7 (Y)	PA 10	MS 35 (2)	MA 7-50 (Y)	PA 10-50	MS 35-50 (2)	MA 7 (Y)	PA 10	MS 35 (2)
	50	35	T 50 - M..	L 50 - T..		MA 10 (Y)		MS 50 (2)	MA 10-50 (Y)		MS 50-50 (2)	MA 10 (Y)		MS 50 (2)
	70	50	T 70 - M..	L 70 - T..			MS 70 (2)	MA 14-50 (Y)	PA 19-50	MS 70-50 (2)			MS 70 (2)	
	95	70	T 95 - M..	L 95 - T..			MS 95 (3)			MS 95-50 (3)			MS 95 (3)	
	120	95	T 120 - M..	L 120 - T..			MS 120 (3)			MS 120-50 (3)			MS 120 (3)	
	150	120	T 150 - M..	L 150 - T..			MS 150L (4)			MS 150L-50 (4)			MS 150 (3)	
	185	150	T 185 - M..	L 185 - T..										
	240	185	T 240 - M..	L 240 - T..										
	300	240	T 300 - M..	L 300 - T..										
	400	300	T 400 - M..	L 400 - T..										

CONDUCTOR	CONNECTOR		HYDRAULIC TOOLS														
			HT 51 RH 50 B 51			HT 81-U RHU 81		HT120 and tools and heads with 130 kN crimping force			ECW-H3D			RHU 230-630			
low stranded	flexible	LUGS	SPLICE	NEST	PUNZONE	DIE SET	DIE SET	DIE SET	NEST	INDENTOR	DIE SET	NEST	INDENTOR	DIE SET	NEST	INDENTOR	DIE SET
4 ÷ 6		T 6 - M..	L 6 - T..	MA 1-50 (Y)	PA 1-50	MS 6-50 (1)		MS 6-10-U (1)			MS 6-C (1)						
10		T 10 - M..	L 10 - T..	MA 2.3-50 (Y)	PA 5-50	MS 10-50 (1)		MS 6-10-U (1)	MA 2-C (Y)	PA 10-C	MS 10-C (1)	Adaptor AU 230-130 D with die set MA.-C and indentor PA.-C	Adaptor AU 230-130 D with die set MS.-C	Adaptor AU 230-130 D with die set MA.-C and indentor PA.-C	Adaptor AU 230-130 D with die set MS.-C		
16		T 16 - M..	L 16 - T..			MS 16-50 (1)	MA 3.5-U (Y)	MS 16-25-U (1)	MA 3-C (Y)		MS 16-C (1)						
25		T 25 - M..	L 25 - T..	MA 5-50 (Y)	PA 10-50	MS 25-50 (1)		MS 16-25-U (1)	MA 5-C (Y)	MS 25-C (1)							
35	25	T 35 - M..	L 35 - T..	MA 7-50 (Y)		MS 35-50 (2)	MA 7.14-U (Y)	MS 35-50-U (1)	MA 7-C (Y)	MS 35-C (1)							
50	35	T 50 - M..	L 50 - T..	MA 10-50 (Y)	PA 19-50	MS 50-50 (2)	MA 10.19-U (Y)	MS 35-50-U (2)	MA 10-C (Y)	MS 50-C (1)							
70	50	T 70 - M..	L 70 - T..	MA 14-50 (Y)		MS 70-50 (2)	MA 9.17-U (Y)	MS 70-150-U (2)	MA 14-C (Y)	MS 70-C (1)							
95	70	T 95 - M..	L 95 - T..	MA 19-50 (Y)	MS 95-50 (3)	MA 10.19-U (Y)	MS 95-120-U (2)	MA 19-C (Y)	MS 95-C (1)								
120	95	T 120 - M..	L 120 - T..	MA 24-50 (Y)	PA 24-50	MS 120-50 (3)	MA 24-U (Y)	MS 95-120-U (2)	MA 24-C (Y)	MS 120-C (1)							
150	120	T 150 - M..	L 150 - T..			MS 150-50 (3)	MA 30.80-U (Y)	MS 70-150-U (3)	MA 30-C (Y)	MS 150-C (1)							
185	150	T 185 - M..	L 185 - T..			MS 185-50 (4)	MA 35-U (Y)	MS 185-U (3)	MA 37-C (Y)	MS 185-C (1)							
240	185	T 240 - M..	L 240 - T..			MS 240-50 (4)	MA 48-U (Y)	MS 240-U (4)	MA 48-C (Y)	MS 240-C (2)							
300	240	T 300 - M..	L 300 - T..						MA 60-C (Y)	PA 60-C	MS 300-C (3)						
400	300	T 400 - M..	L 400 - T..								MS 400-C (3)						

N.B.: Number inside symbol indicates the number of crimps on T-M barrel.

Cembre SpA

Via Serenissima, 9 - 25135 Brescia (Italy)

Tel.: +39 030 36921 - Fax: +39 030 3365766

Web: www.cembre.com - Email: info@cembre.com