

PRODUCT-DETAILS

# KLC-A Key lock open Kirk XT5-XT6

## KLC-A Key lock open Kirk XT5-XT6

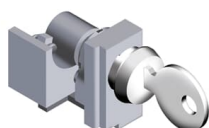

### General Information

Extended Product Type	KLC-A Key lock open Kirk XT5-XT6
Product ID	1SDA105067R1
EAN	8015644071592
Catalog Description	KLC-A Key lock open Kirk XT5-XT6
Long Description	KEY LOCK KIRK IN OPEN (PREDISPOSITION ONLY) XT5-XT6

### Ordering

EAN	8015644071592
Minimum Order Quantity	1 piece
Customs Tariff Number	85389099

### Dimensions

Product Net Width	200 mm
Product Net Height	50 mm
Product Net Depth / Length	250 mm
Product Net Weight	0.1 kg

### Container Information

Package Level 1 Units	1 piece
-----------------------	---------

Package Level 1 Width	200 mm
Package Level 1 Height	50 mm
Package Level 1 Depth / Length	250 mm
Package Level 1 Gross Weight	0.1 kg
Package Level 1 EAN	8015644071592

### Additional Information

Configuration Type	Loose or configurable
Order Multiple	1 piece
Product Main Type	Accessories for Tmax XT
Product Name	Accessory
Product Type	ACC
Standards	IEC, UL
Suitable For	XT5 XT6
Suitable for Product Class	SACE Tamx XT

### Certificates and Declarations (Document Number)

Data Sheet, Technical Information	1SDC210100D0205 1SDC210200D0205
Instructions and Manuals	1SDH002011A1606

### Classifications

ETIM 6	EC002498 - Accessories for low-voltage switch technology
ETIM 7	EC002498 - Accessories for low-voltage switch technology
WEEE Category	5. Small Equipment (No External Dimension More Than 50 cm)

### Categories

Low Voltage Products and Systems → Circuit Breakers → Moulded Case Circuit Breakers → Accessories for Tmax XT

