

Contact us
ABB STOTZ-KONTAKT GmbH
Eppelheimer Str. 82
69123 Heidelberg
Germany
www.abb.com/lowvoltage



Warning! Installation by person with
electrotechnical expertise only.
Warnung! Installation nur durch
elektrotechnische Fachkraft.
Avvertenza! Fare installare solo
da un elettricista qualificato.

de Arbeitsstromauslöser
en Shunt trip
fr Bloc déclencheur
it Bobina di apertura a lancio di corrente
es Bobina de emisión de corriente
cn 分励脱扣器
ru Дистанционный расцепитель

0.8 Nm
1 wire 0.75 ... 2.5 mm²/AWG 18-14
2 wires max. 2x1.5mm²/AWG 18-16
max. 2 wires per slot
7 ... 8 mm/0.28 ... 0.32 In
CU only

S200
S200 M
S200 MT/S200 MTR
S200 P
S200 MUC
S300 P
VY30

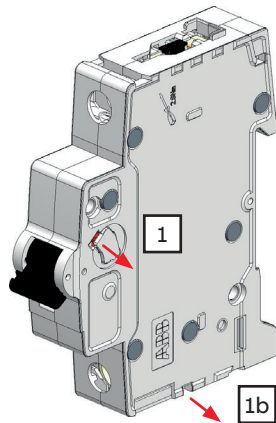

1b Remove only for S300 P, S200 MTR

F200
RCCB VY

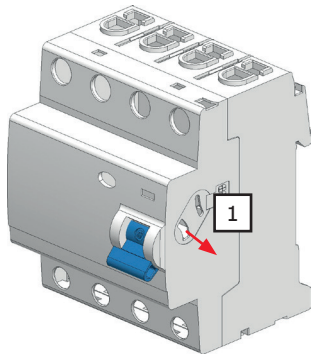

2 Use fork A

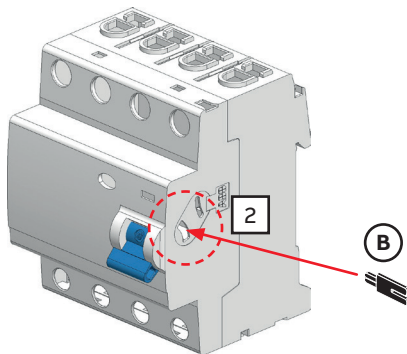

2 Use fork B

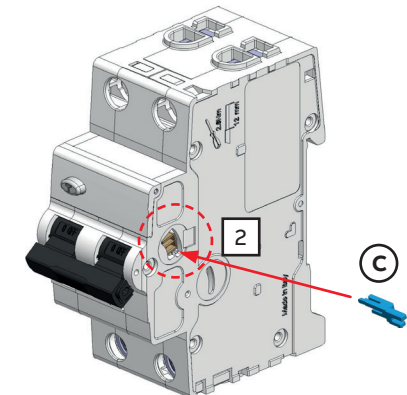

2 Use fork C

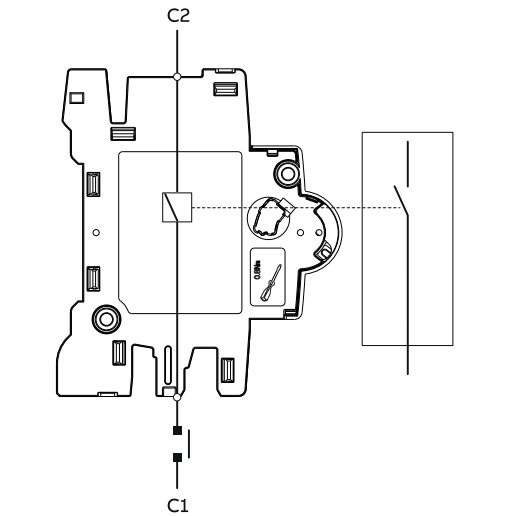

A S200
S200 M
S200 MT/S200 MTR
S200 P
S200 MUC
S300 P
VY30
UP
DOWN
Color: White

B F200
RCCB VY
SN201
DS203NC
Color: Black

C S-ARC1
DS-ARC1
DSE201 M
DS201
S3C-MOD
F3C-AR
UP
DOWN
Color: Blue

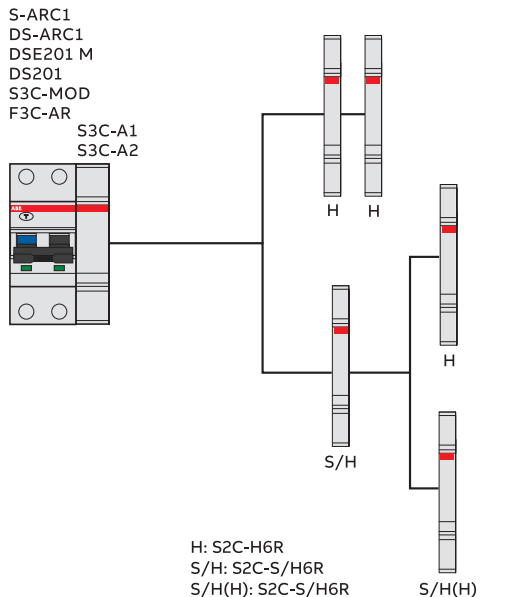
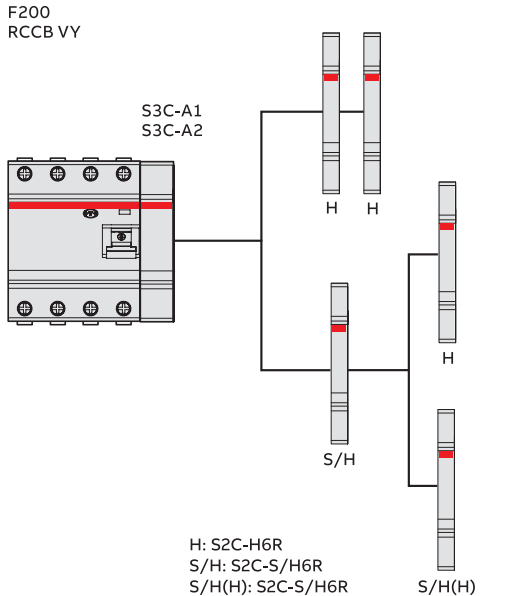
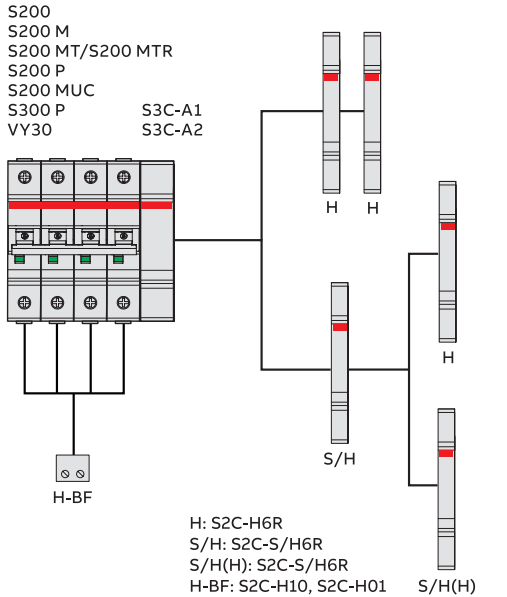

SN201 + SN201-IH
DS203NC + SN201-IH

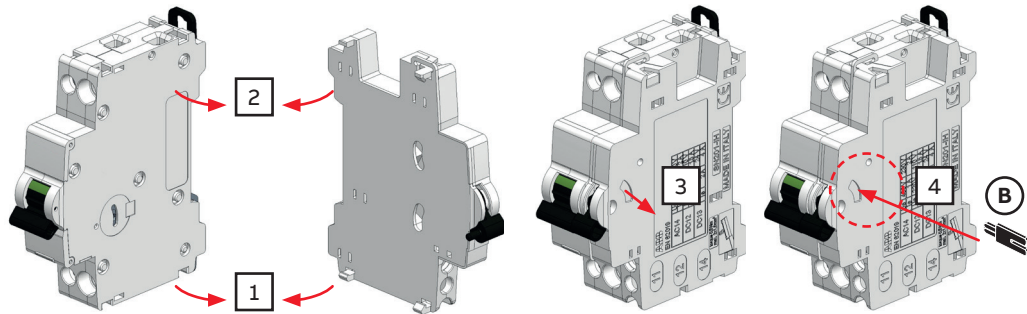

4 Use fork B

DS301C + SCC-IH6R/SCC-S6R
SN201 + SCC-IH6R/SCC-S6R
DS203NC + SCC-IH6R/SCC-S6R

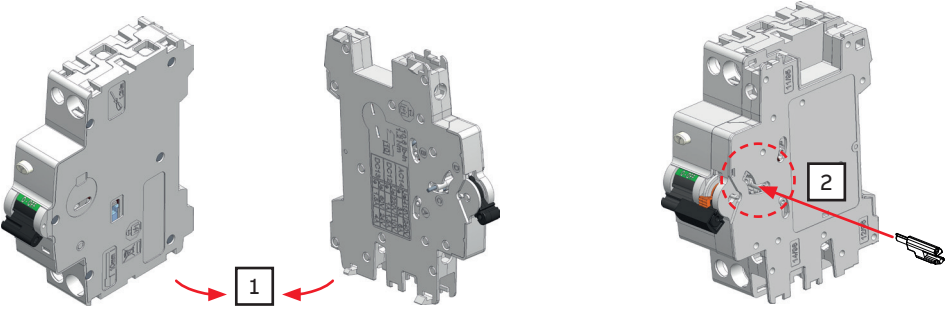

1 Check the instruction sheet of SCC-IH6R/SCC-S6R for more detailed information

2 For this step, use the fork included in the package of SCC-IH6R/SCC-S6R

		S3C-A1				
Rated voltage	AC	V	12...110			
	DC	V	12...110			
Max. release duration		ms	<10 @ Rated voltage			
Min. release voltage	AC	V	8.4			
	DC	V	10			
Power consumption	Ub	V	12 V DC	12 V AC	24 V DC	24 V AC
	Ib _{max} /A	A	2.8	3.3	5.3	6.2
	Ub	V	60 V DC	60 V AC	110 V DC	110 V AC
	Ib _{max} /A	A	14	15	25.3	25
Coil resistance		Ω	4			
Tightening torque		Nm	0.8			
Dimensions (H x D x W)		mm	85 x 74.1 x 17.4			

		S3C-A2				
Rated voltage	AC	V	110...415			
	DC	V	110...250			
Max. release duration		ms	<10 @ Rated voltage			
Min. release voltage	AC	V	77			
	DC	V	77			
Power consumption	Ub	V	110 V DC	110 V AC	220 V DC	
	Ib _{max} /A	A	0.5	0.7	1.1	
	Ub	V	230 V AC	250 V DC	415 V AC	
	Ib _{max} /A	A	1.5	1.2	2.5	
Coil resistance		Ω	210			
Tightening torque		Nm	0.8			
Dimensions (H x D x W)		mm	85 x 74.1 x 17.4			

Busbar PS pass-through TOP and BOTTOM ✓
Caution: When using S3C-A1 and S3C-A2 with **OTHER** busbar types, make sure that routing cable is not contacting with the pin of the busbar. Take into account also high bending radius.

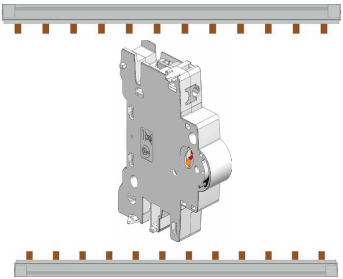

Caution: When positioning the device on the edge, it must be positioned outside the busbar.
Protection against contact with the connection pins of the busbar must be ensured through suitable selection of the busbar, device positioning and covers.

SN201
DS203NC

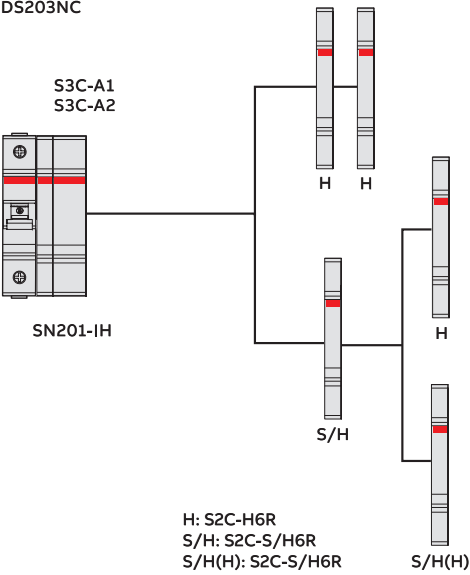

DS301C
SN201
DS203NC

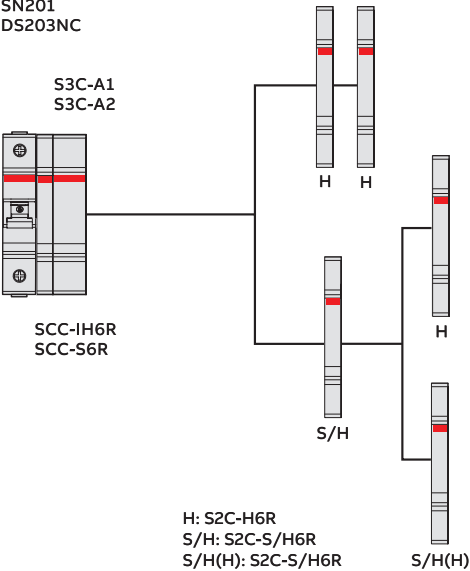

Dimensional drawing

