

**P31 HD - Cover Flat Bend 90°  
R100 mm PG**

Reference(s) : 347 623 to 627

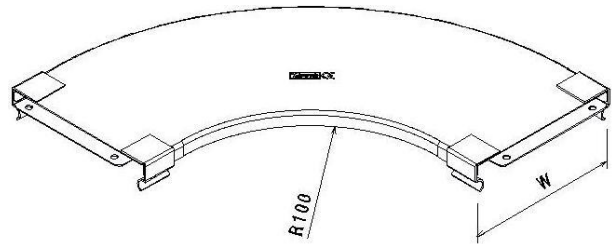
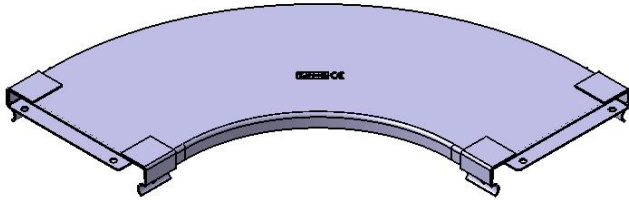

Ref.	Description	Raw Material (R.M.)	R.M. Standard	Coating Standard	W (mm)	Thickness (mm)	Weight (kg)
347 623	Cover Flat Bend 90° W75 R100	DX51D Z275 (RE MIN 220 MPA)	EN10346	//	77	0.8	0.2
347 624	Cover Flat Bend 90° W100 R100	DX51D Z275 (RE MIN 220 MPA)	EN10346	//	100	0.8	0.25
347 625	Cover Flat Bend 90° W150 R100	DX51D Z275 (RE MIN 220 MPA)	EN10346	//	150	0.8	0.45
347 626	Cover Flat Bend 90° W200 R100	DX51D Z275 (RE MIN 220 MPA)	EN10346	//	200	0.8	0.65
347 627	Cover Flat Bend 90° W300 R100	DX51D Z275 (RE MIN 220 MPA)	EN10346	//	300	0.8	1.1