

## P31HD - Cover Crosspieces

### W400→600 mm PG

Reference(s) : 347 655 to 657

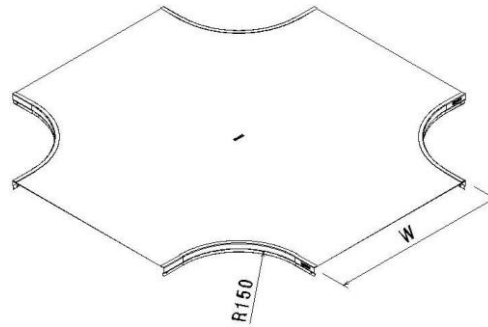
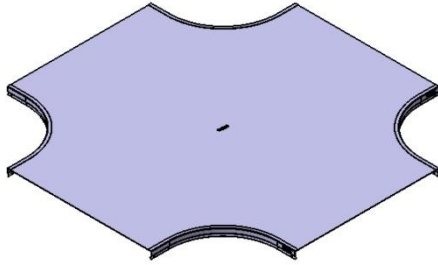

Ref.	Description	Raw Material (R.M.)	R.M. Standard	Coating Standard	W (mm)	Thickness (mm)	Weight (kg)
347 655	Cover Flat T W400	DX51D Z275 (RE MIN 220 MPA)	EN10346	//	400	1	3.4
347 656	Cover Flat T W500	DX51D Z275 (RE MIN 220 MPA)	EN10346	//	500	1	4.5
347 657	Cover Flat T W600	DX51D Z275 (RE MIN 220 MPA)	EN10346	//	600	1	4.9