

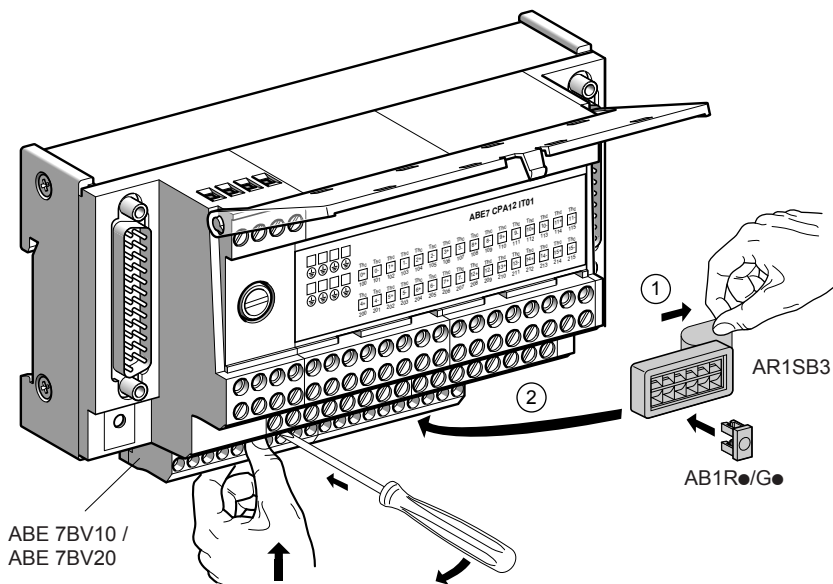

W914891550111

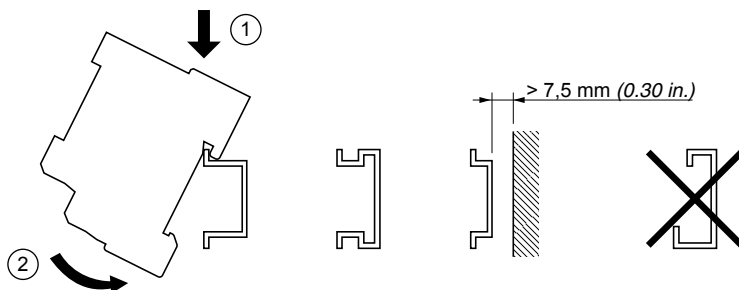

Installation
Montage
Montage
Montaje



⚠ DANGER / DANGER / PELIGRO

HAZARDOUS VOLTAGE

- Disconnect all power before servicing equipment.

Failure to follow this instruction will result in death or serious injury.

TENSION DANGEREUSE

- Coupez l'alimentation avant de travailler sur cet appareil.

Le non-respect de cette instruction entrainera la mort ou des blessures graves.

TENSION PELIGROSA

- Desenergice el equipo antes de realizarte servicio.

Si no se respetan estas instrucciones, se producirán graves daños corporales o la muerte.



Wiring min ... max
 Raccordement mini ... maxi
 Anschlüsse min ... max
 Capacidad de conexión min ... max

| | | | | | |
|-----------------|------------|-------------|------------|----------|------------|
| | | | | | |
| mm ² | 0.14...1.5 | 0.14...0.75 | 0.14...2.5 | 0.14...4 | 0.14...1.5 |
| AWG | 26...16 | 26...18 | 26...14 | 26...12 | 26...16 |

| | | | | |
|--|-------------------------|--|------------|-----|
| | Ø 3.5 mm Ø 0.138 in. | | Nm | 0.6 |
| | | | pound-inch | 5.4 |

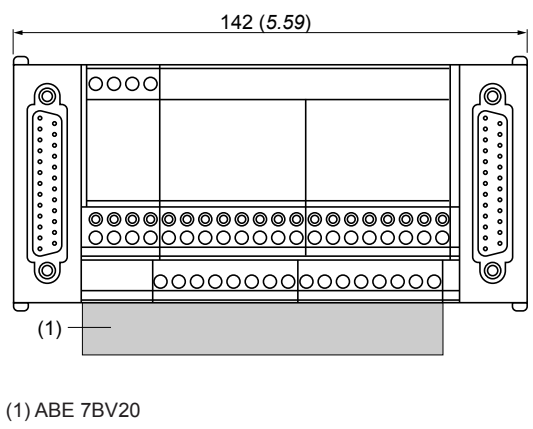
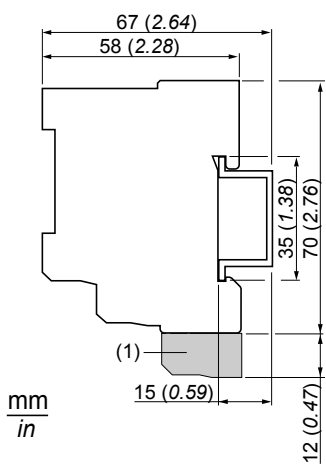
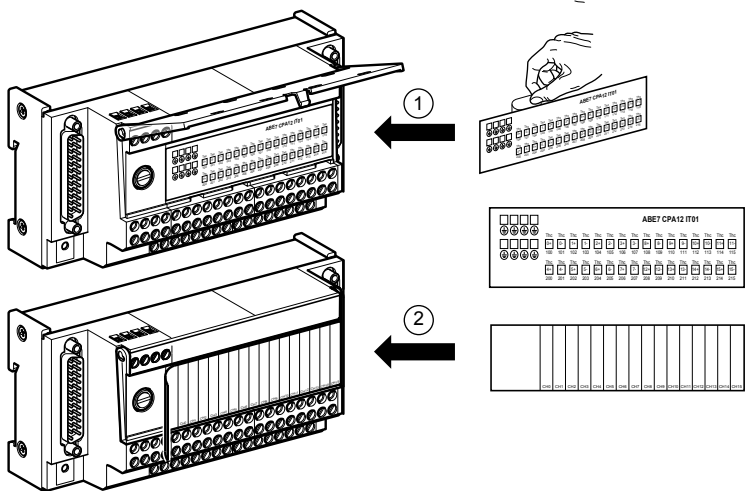

Connection/Wiring / Raccordements / Anschlüsse / Conexiones

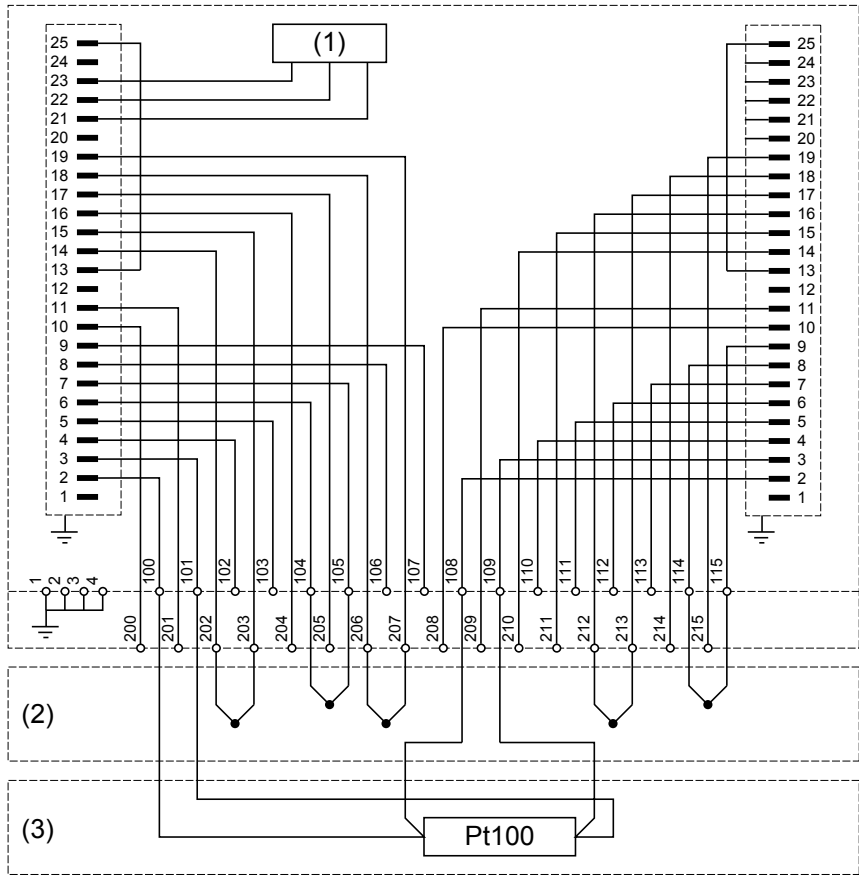

- (1) Temperature probe / Sonde de température / Temperatur fühler / Sonda de temperatura
- (2) Utilisation in cold soldering compensation mode inside the Telefast sub-base /
Utilisation en mode compensation de soudure froide dans l'embase Telefast /
Anwendung bei Ersatz der Kalt schweißung in der Bodenplatte Telefast /
Utilización de la soldadura fría en modo compensación en la base Telefast
- (3) Utilisation in cold soldering compensation mode via external 4-wire Pt100 /
Utilisation en mode compensation de soudure froide par Pt100 4 fils externes /
Anwendung bei Ersatz der Kalt schweißung durch Pt100 4 Außenleitungen /
Utilización de la soldadura fría en modo compensación con los 4 alambres externos Pt100

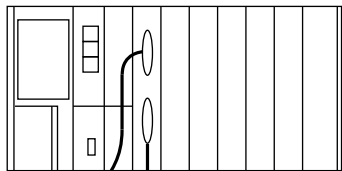

TSX
AEY 1014

TSX CAP030

TSX CAP030

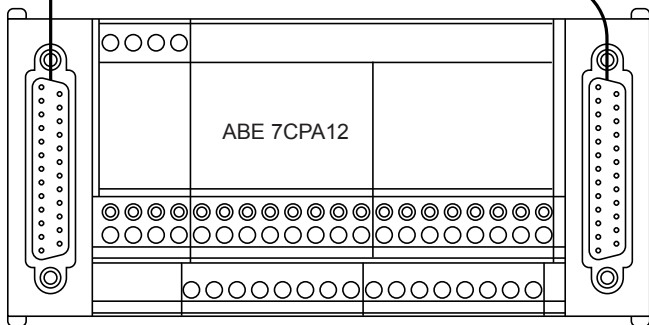

ABE 7CPA12