

- **Présentation**
- **Voorstelling**
- **Presentation**
- **Aufmachung**
- **Presentación**
- **Presentazione**
- **Apresentação**
- **Представление**
- **الشكل**

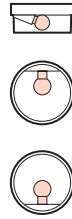
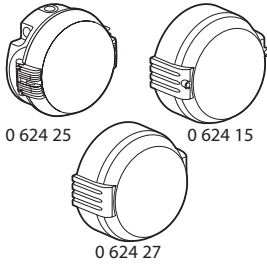

ERP : 850°C

IP 54

0 624 25/27 : IK 08 (5 J)

0 624 15 : IK 09 (10 J)

EN60-598-1

E27 70 W	E27 20 W	E27 12 W

- Non fournie
- Niet geleverd
- Not supplied
- Getrennt zu bestellen
- No suministrada
- Non fornita
- Não fornecido
- Не поставляется
- غير مؤرّدة



- **Installation**
- **Instalación**
- **Installatie**
- **Installazione**
- **Instalação**
- **Монтаж**
- **التركيب**

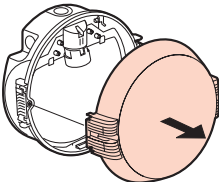
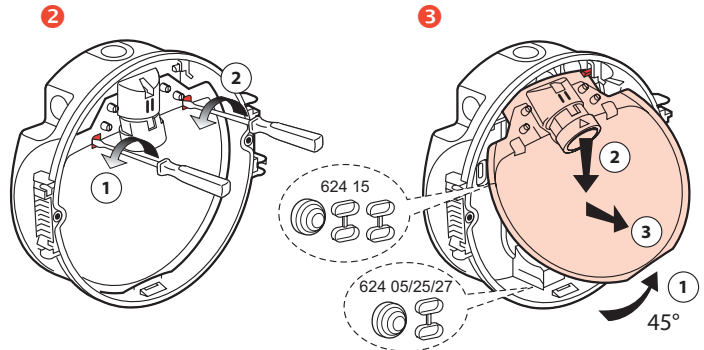
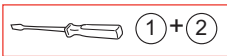
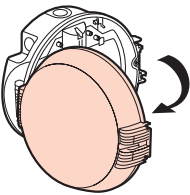
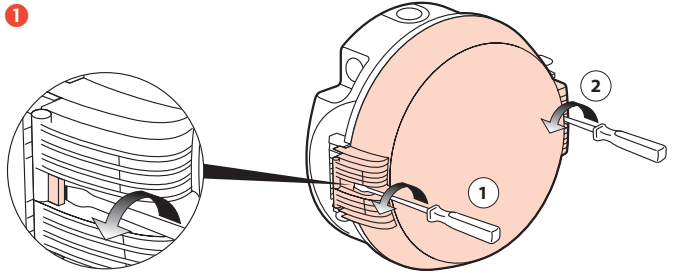
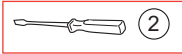
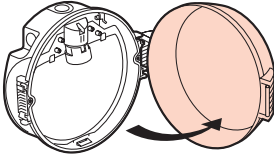
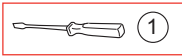
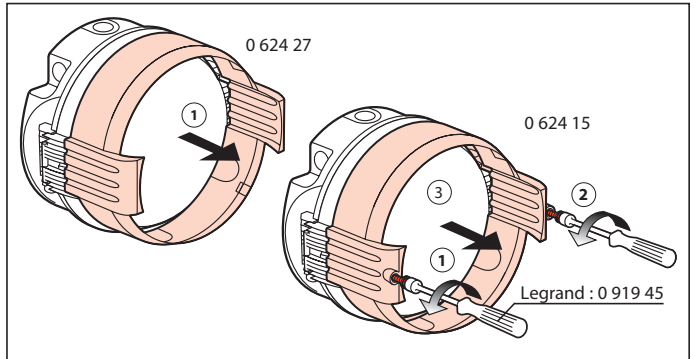

- **Installation** (suite)
- **Installatie** (vervolg)
- **Installation** (continued)
- **Montage** (Fortsetzung)
- **Instalación** (cont.)
- **Instalazione** (segue)
- **Instalação** (continuação)
- **Монтаж** (продолжение)
- التركيب (تابع)

2 bis

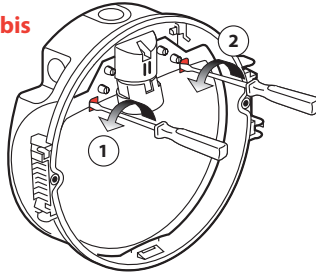

3 bis

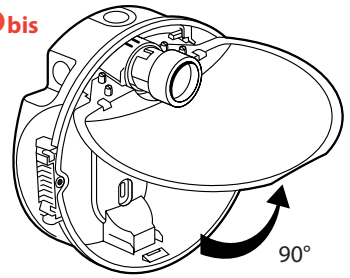

- **Arrivée des conducteurs**
- **Aankomst van de geleiders**
- **Incoming conductors**
- **Leitungseinführung**
- **Llegada de cables**
- **Entrata cavi**
- **Entrada de condutores**
- **Ввод проводников**
- الموصلات الآتية

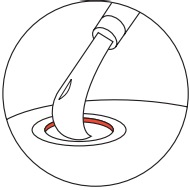
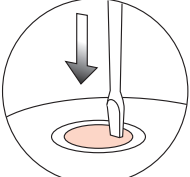
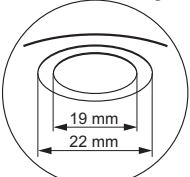
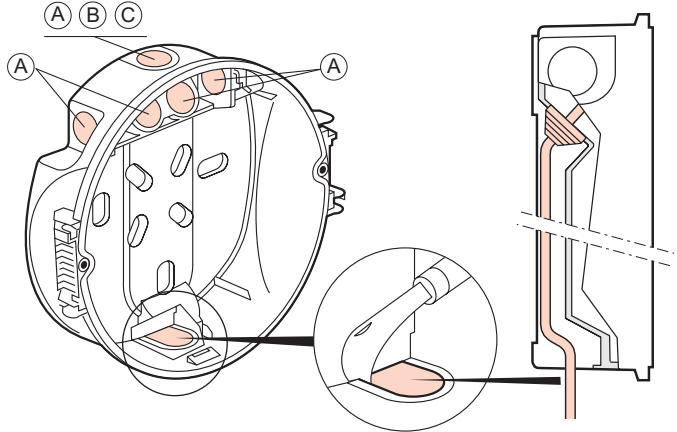

A	B	C
	ISO 20 + 0 980 86 + 0 980 32	PG 11 + 0 980 32
<ul style="list-style-type: none"> <li>• ou</li> <li>• of</li> <li>• or</li> <li>• oder</li> <li>• o</li> <li>• o</li> <li>• ou</li> <li>• или</li> <li>• أو</li> </ul>	<ul style="list-style-type: none"> <li>• ou</li> <li>• of</li> <li>• or</li> <li>• oder</li> <li>• o</li> <li>• o</li> <li>• ou</li> <li>• или</li> <li>• أو</li> </ul>	<ul style="list-style-type: none"> <li>• ou</li> <li>• of</li> <li>• or</li> <li>• oder</li> <li>• o</li> <li>• o</li> <li>• ou</li> <li>• или</li> <li>• أو</li> </ul>

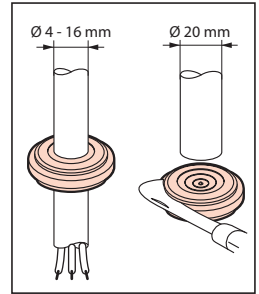

- **Moulure type DLP**
- **Lijst type DLP**
- **DLP type moulding**
- **Leitungseinführung-Kabelkanal DLP**
- **Canal tipo DLP**
- **Minicanali tipo DLP**
- **Rodaré tipo DLP**
- **Профиль DLP**
- مجاري بلاستيكية لتتمرير الكوابل

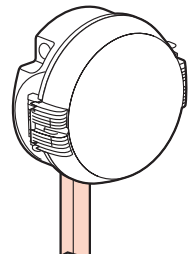
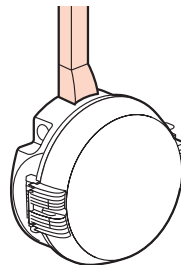
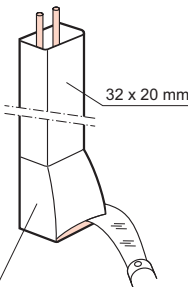

Legrand : 0 303 34/40

- Fixation
- Bevestiging
- Extension
- Befestigung
- Fijación
- Fissaggio
- Fixação
- Крепление
- التثبيت

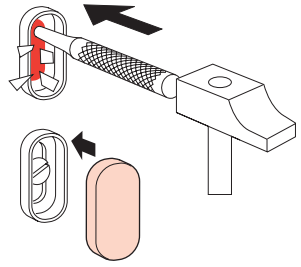
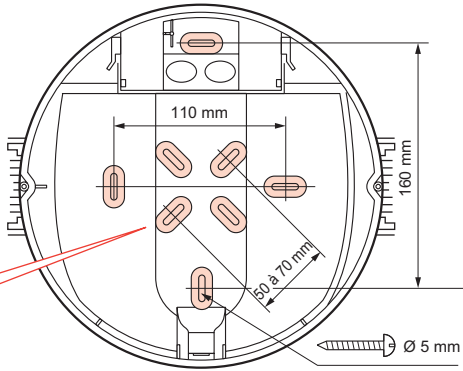
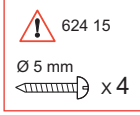

- Raccordement
- Aansluiting
- Connections
- Anschließen
- Conexión
- Collegamento
- Ligação
- Соединение
- التوصيل

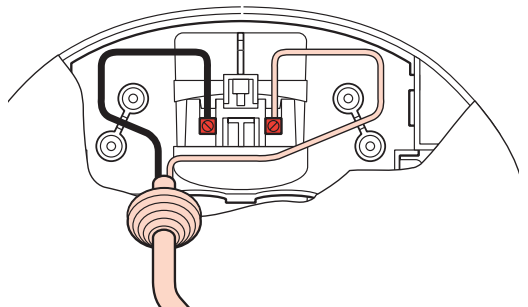
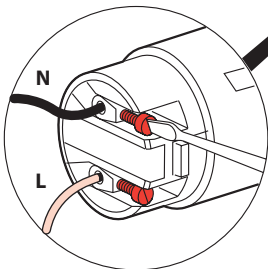
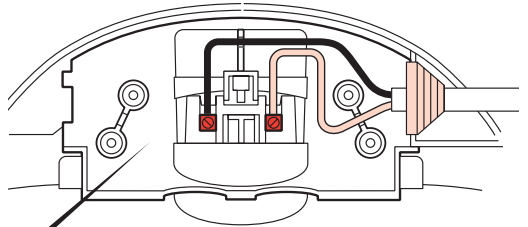
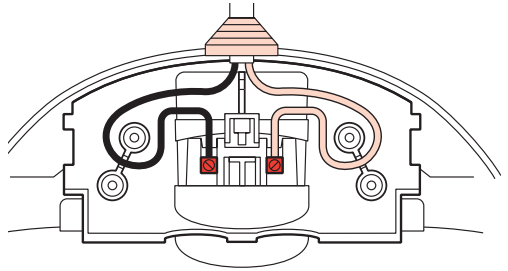
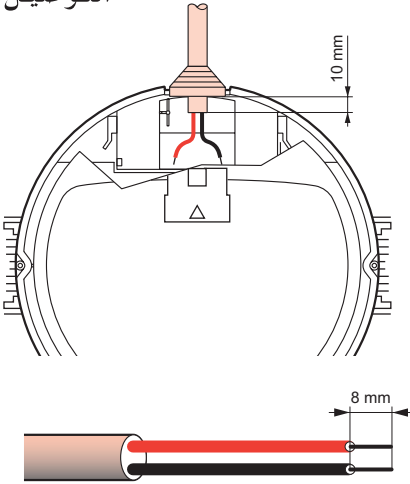

- Remontage
- Hermontage
- Reassembly
- Montage
- Montaje
- Montaggio
- Montagem
- Обратная сборка

• إعادة التجميع

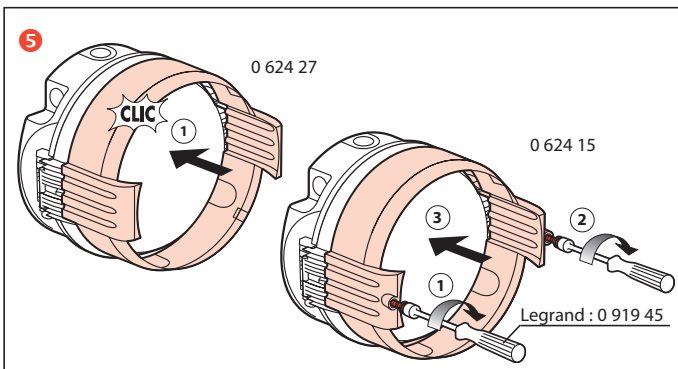
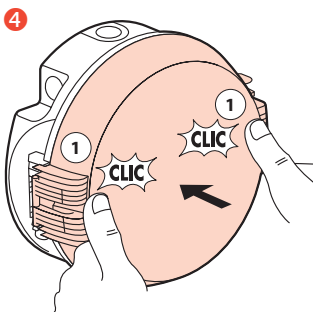
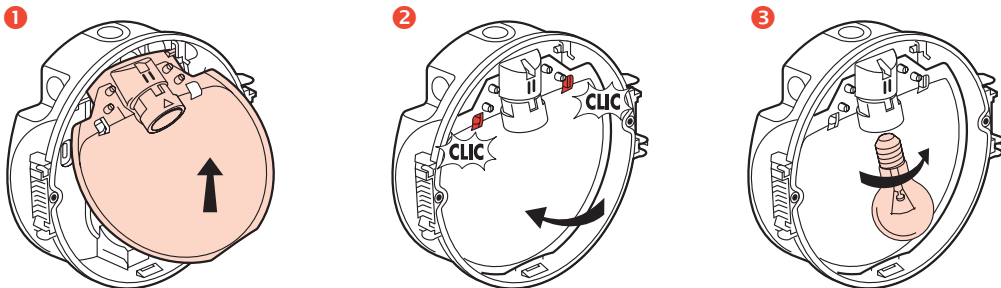

- Maintenance
- Onderhoud
- Maintenance
- Wartung
- Mantenimiento
- Manutenzione
- Manutenção
- Обслуживание
- الصيانة

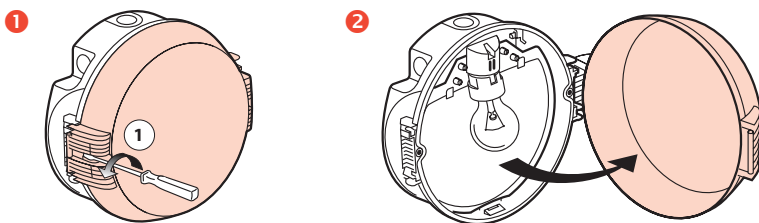

- Extension
- Uitbreiding
- Extension
- Anschließen weiterer leuchten
- Extensión
- Derivazione
- Extensão
- Дополнительные подключения
- التفريع

