

	100 - 240 V~
	50 / 60 Hz
	2 x 2,5 mm ²
	-5°C / +45°C
	PIR
	500 lux
	15 mn
	Ø 8 m



230 V~	2000 W	8,5 A	1000 VA	4,3 A	10 x (2x36W)	4,3 A	500 VA	2,1 A	1000 VA	4,3 A	500 VA	2,1 A	I max. ≤ 2A
110 V~	1000 W		500 VA		5 x (2x36W)		250 VA		500 VA		250 VA		





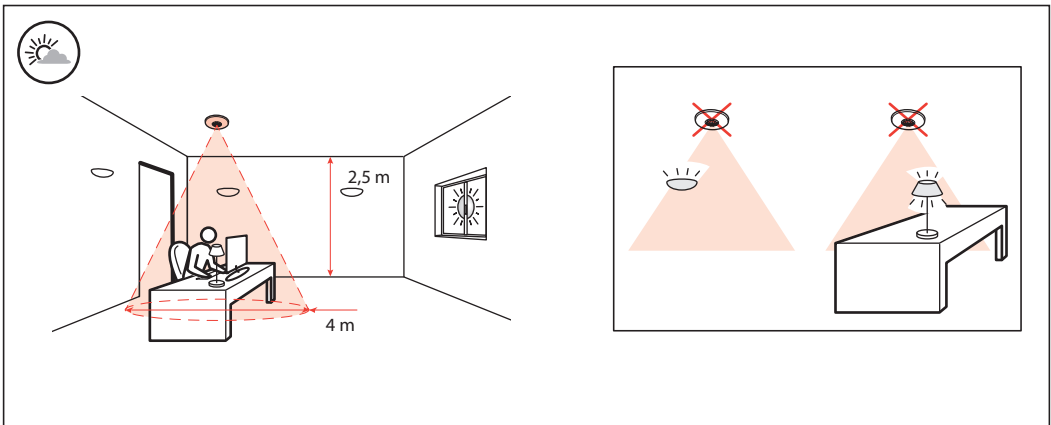
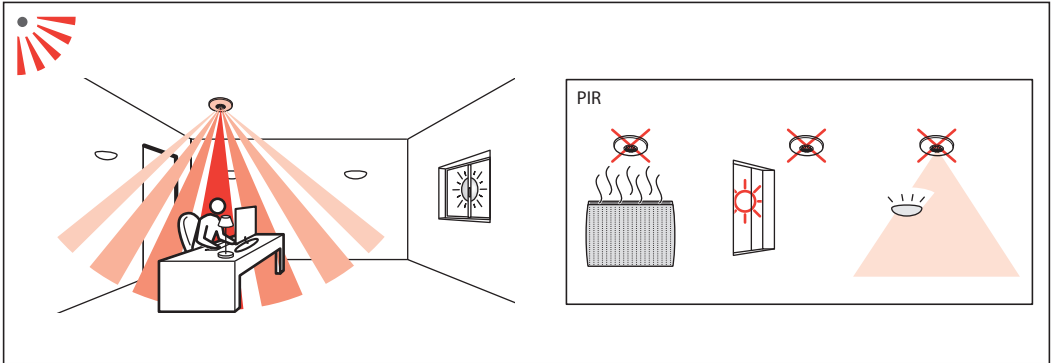
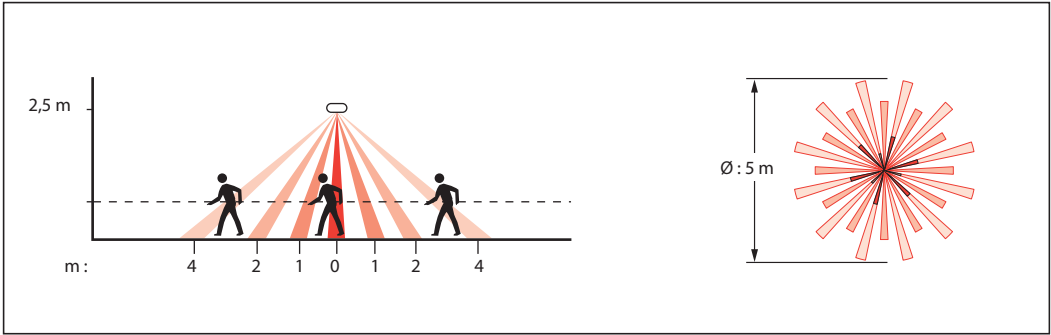
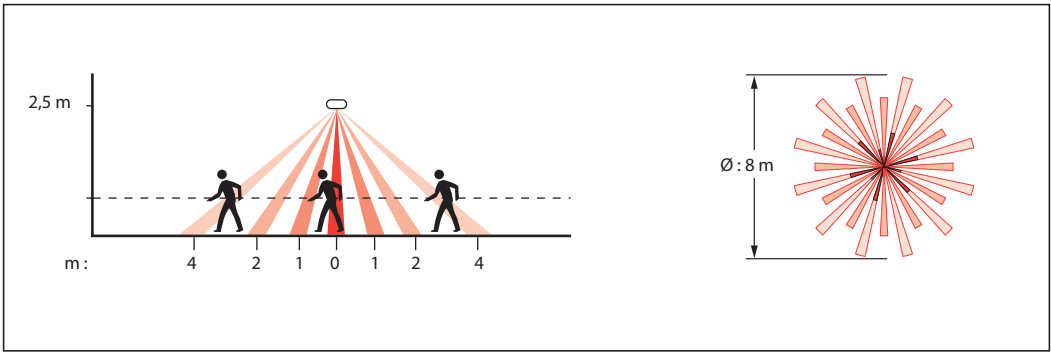

230 V~	500 VA	2 A	I max. ≤ 2A
110 V~	250 VA		
U ≤ 30 V=	2 A maxi		

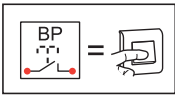
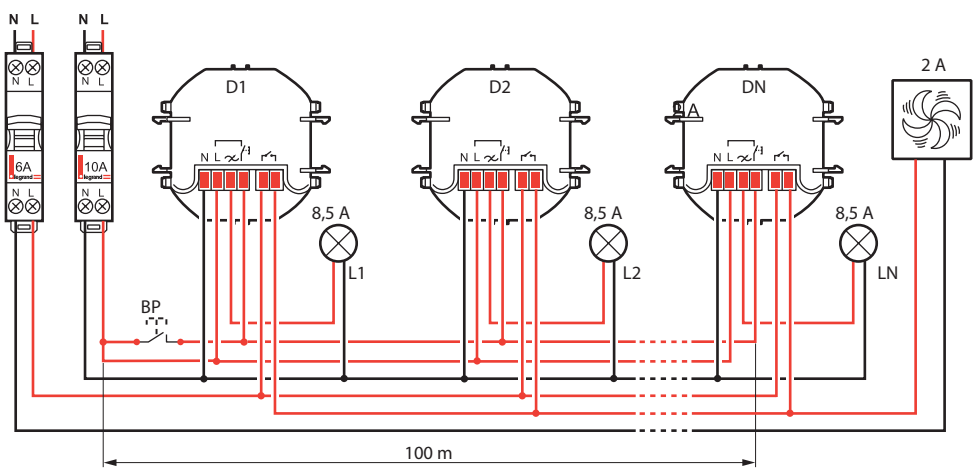
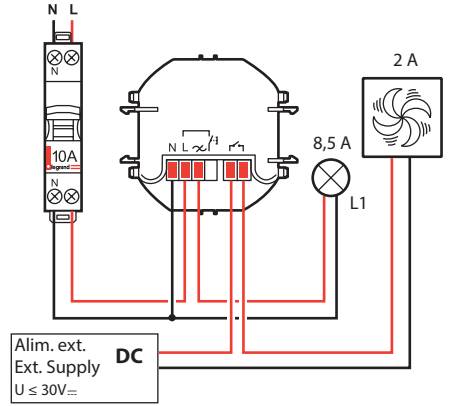
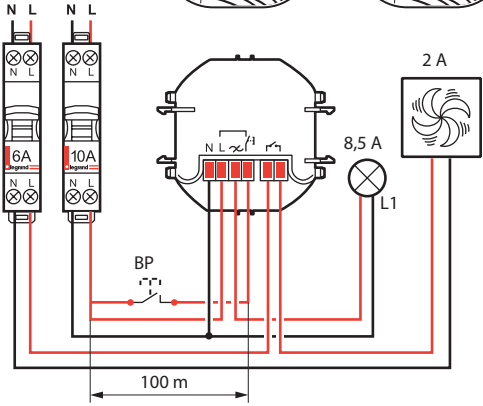
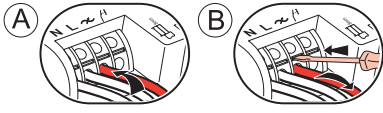

230 V~
110 V~



- Inversion de l'état des charges :  < 1 s
- Reversal of load status :
- Synchronisation de toutes les charges à ON :  > 1 s
- Switching all loads to ON :
- Synchronisation de toutes les charges à OFF :  > 1 s +  < 1 s
- Switching all loads to OFF :

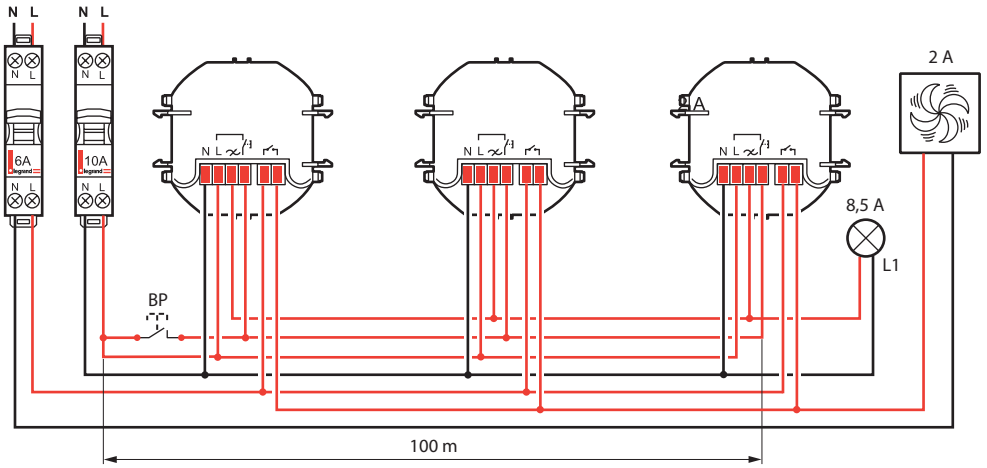

- Etat des charges ON :
- Load status ON :



- Etat des charges OFF :
- Load status OFF :

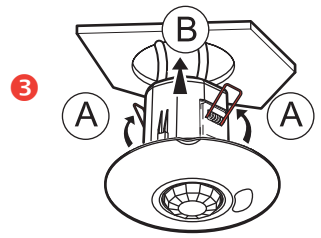
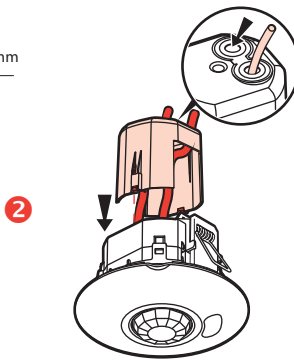
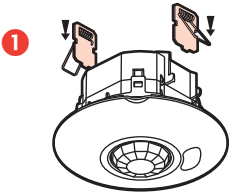
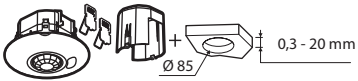

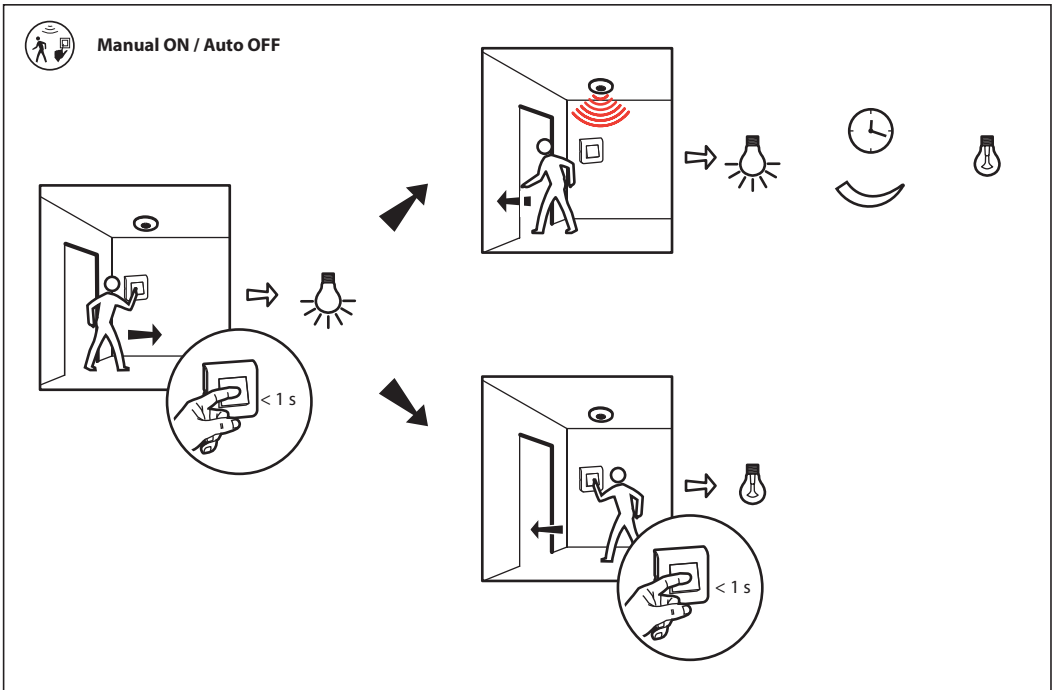
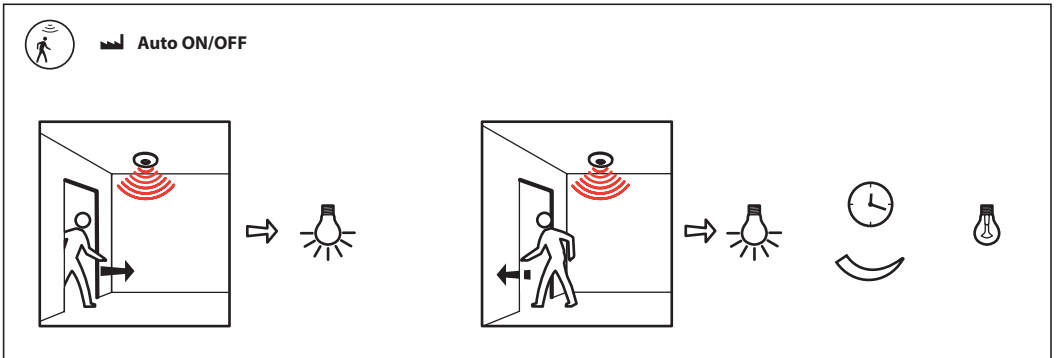
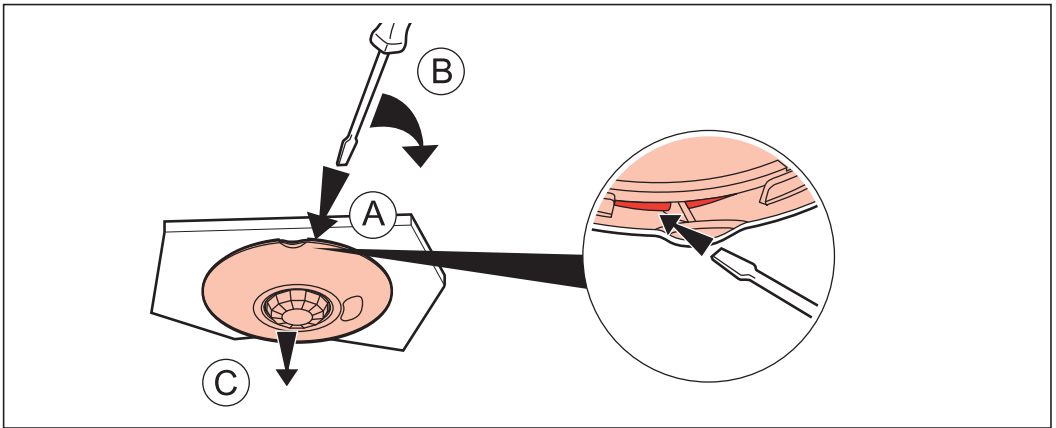



- Réf. 0 882 40 : Passerelle de configuration
- Cat. No(s) 0 882 40 : Configuration tool

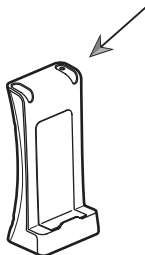

&



App Store



Google Play



Application: «Legrand Close Up»

- Pour plus de renseignement sur les paramètres, reportez vous à la fiche technique de la passerelle de configuration Réf. 0 882 40.
- For more information about setting parameters, refer to the data sheet for the configuration gateway Cat. No. 0 882 40.

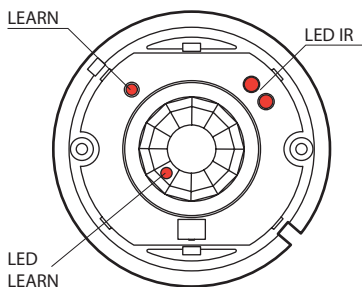

	5 - 1275 lux
	5 sec - 59 min 59 sec
	25% - 50% - 75% - 100%
Mode	Auto - Manual - Walkthrough