



Paulmann

Safety Instructions

1, 2, 3, 4, 5, 6, 7, 8, 28, 33, 34



Info

www.paulmann.com

Paulmann Licht GmbH
Quezinger Feld 2
31832 Springe
Germany

www.paulmann.com

Art.-Nr. : 667.07
(+MA 326) PAS01/18

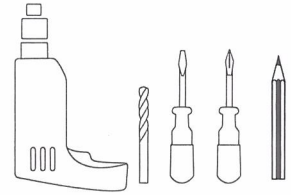
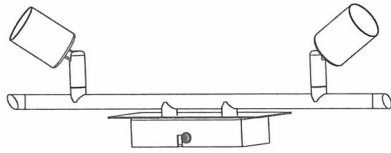

CE

Incl.



A

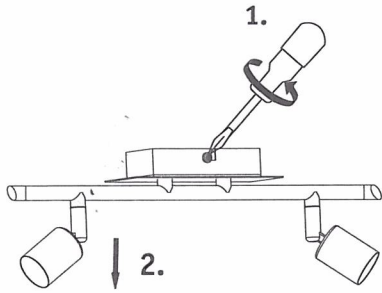

B

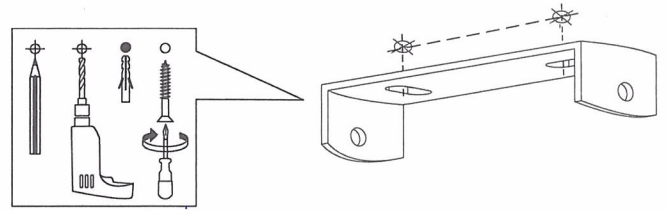

C

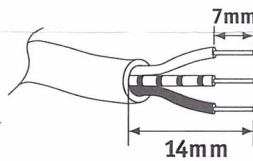

230V

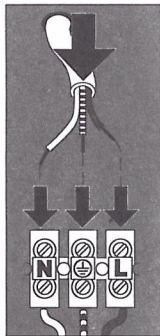

D

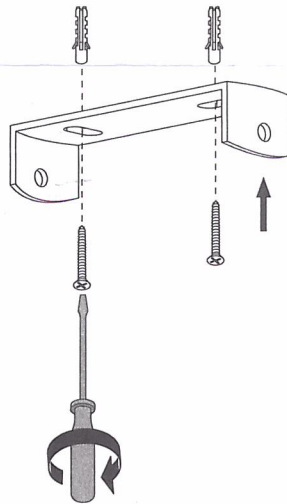

E

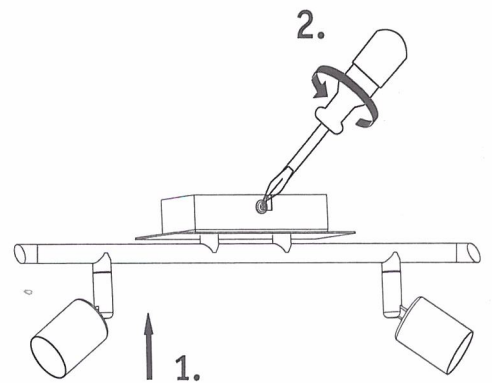

F

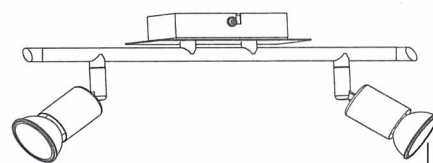
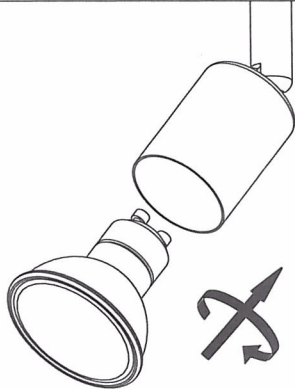

>0.5m = [] - - - 0,5m